

**M12-PANEL FEED THROUGH 8POLE A CODED**

Control cabinet entry system

Male - female

M12, 8-pole

A-coded

shielded

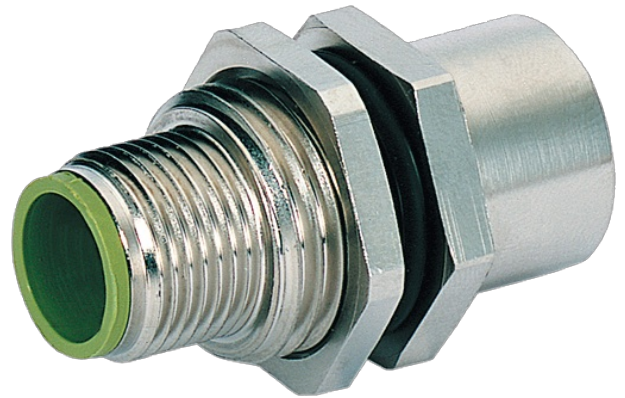
[Link to Product](#)**Illustration**

Product may differ from Image

**Form**

Form 48111

**General data**

Pollution Degree 3

Mounting set M16×1.5 mm

Temperature range -25...+85 °C

**Technical Data**

Operating voltage max. 30 V AC/DC

Rated surge voltage 0.8 kV

Operating current per contact max. 2 A

Material group IEC 60664-1, category I

Coding A-coded

Locking of ports Screw thread (M12×1 mm) recommended torque 0.6 Nm, self-securing

Protection IP65 and IP67 when plugged and screwed down (EN 60529)

Material Brass, nickel plated

**Commercial data**

country of origin CZ

customs tariff number 85366990

EAN 4048879138871

eClass 27279220

Packaging unit 1

**Sketch**

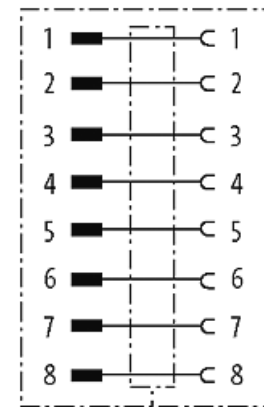
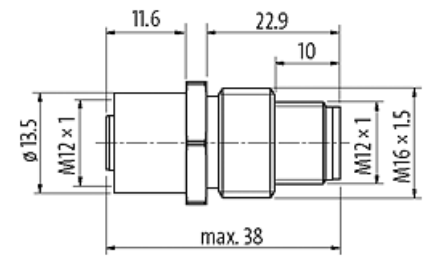
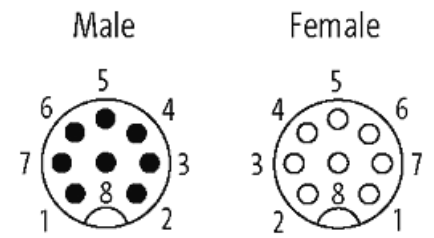

Product may differ from Image